

No.10

中原大学

Chung Yuan Christian University



大学概要

1995年に創立された桃園にあるキリスト教の大学である。7学部あり、商学部は2015年にAACSB（経営学教育評価）に認証された。

世界の253の学校と協定を締結している。大学付近にはレストランや夜市などもあり、生活には便利である。

アクセス

- 中壢鉄道駅から
バスで中原大學全人村駅で下車
 - ・155番線
 - ・156番線



語学に関する情報

- ・留学語学条件
TOEFL IBT 64、TOEIC 700
または、HSK4級
- ・英語での授業の有無 あり
- ・留学生向けの中国語授業 あり

学生寮情報

- 学生寮 あり
- 寄宿料 熱誠宿舍（男/女）16,500 TWD /学期

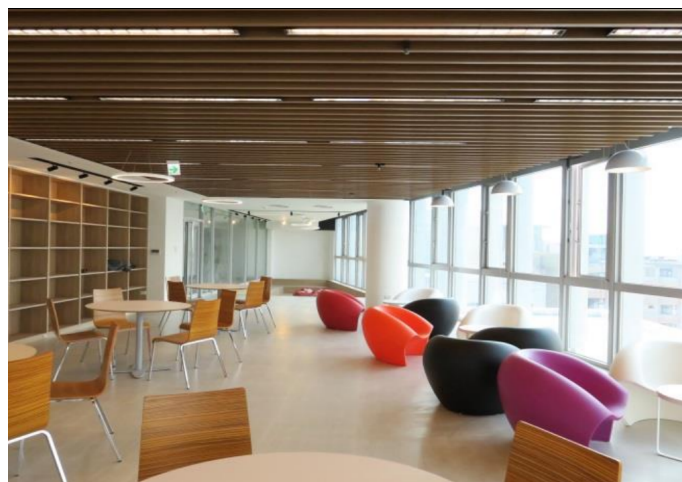

※詳細情報はホームページや資料ご参照ください。

2024 Spring Exchange Student Information of Chung Yuan Christian University

General Information	
Name of institution	Chung Yuan Christian University
Contact person	Ms. I-Wen Chen
Mailing (postal) address	200, Chung Pei Rd, Chung-Li District, Taoyuan City, 32023, Taiwan
Email	incoming_exchange@cycu.edu.tw
Tel	886-3-265-1725
Fax	886-3-265-1729
1 Website	https://oia.cycu.edu.tw/
Major Schedule	
1) Nomination Deadline	31-Oct-23
2) Application Deadline	15-Nov-23
2 3) Beginning Day of 2024 SPRING Semester	19-February, 2024
4) Closure Day of 2024 SPRING Semester	21-June, 2024
5) Class Register Period	19-23 February, 2024
6) Airport Pick up service	17 and 18-February, 2024 (from 10:00 to 19:00)
3 Tuition for University	Waived
Dorm	
1) Room & Fee (not including meals)	-Re Cheng Dorm (only-4 people per room) : NT\$ 16,500 / per person/ per semester.
2) Kitchen	included (Students are not able to cook in the Kitchen, but there are machines for heating up the food.)
3) Facilities - Inside of the Room	desk, bed, air conditioner, bookshelf, wardrobe, phone, shoes cabinet, desk lamp,
4) Facilities - Outside of the Room	conference room, drinking fountain, printer, study room, water dispenser, recreation area
5) Bedding	Students should purchase mattress and blanket by themselves.
6) School Cafeteria Cost	NT\$100-NT\$180 / a regular meal cost
7) Internet Fee	included
8) Other Fee and Information	Re Cheng Dorm- No public PC in dorm. Students need to bring a laptop.
4 9) Photo	
5 Average Living Expense	NT\$450 / day
6 Insurance	please purchase in home country. (Medical and Travel Insurance)
7 Medical Check	Medical Check (for Form C) will be arranged after students arrive in Taiwan (NT\$1000-1500) Form C: Health Certificate for Short-Term Students (one semesters students): Chest X-ray for Tuberculosis and Proof of Positive Measles and Rubella-Antibody or Measles and Rubella Vaccination Certificate.
8 Language & GPA Requirement	TOEFL IBT 64 or IELTS 5 or TOEIC 700 or HSK4. We do not require an official English test score if the student has nationality from an Anglophone country GPA 3.0/4.0.
9 Visa Application Fee and Information	OIA will assist students who have Visitor visa (60 or 90 days) to extend visa before the visa expired date in Taiwan.
Fee Paying Chinese Language Course	
10 1) Condition	Mandarin Learning Center at CYCU, please refer to website (https://mlc.cycu.edu.tw/CYCU/www/default.aspx) Please feel free to contact the following Email (cycumlc@ehuayu.org) if you are interested in learning Mandarin in CYCU Mandarin Learning Center
2) Introduction	Mandarin Learning Center at CYCU that is responsible for offering various Mandarin courses which provide long-term Mandarin courses, one-on-one courses, and short-term Mandarin camps. Both one-on-one course and short-term camps can be customized according to your specific needs. Mandarin Learning Center offer both online and in-person course options.
3) Other Informaion	If student wants to get credits from taking Mandarin classes, they could take the Mandarin courses in Department of Teaching Chinese as a Second Language during semester.
Major Classes for exchange	
11 1) Class information	https://itouch.cycu.edu.tw/active_system/CourseQuerySystem/eng/
2) Other Informaion	Inbound exchange students are required to complete 9 credits min. to 21 credits max (undergraduate students); 3 credits min. to 21 credits max (Graduate or Ph.D. students). Exchange students are not able to enroll in the courses delivered in-service master's program.
12 Official Chapel Class or Church Near the School	We have a chapel on campus; a baptist church and an interdenominational church next to the campus.
13 Other Programs for Exchange Student	Cultural Trip and other activities for international students.
14 On Campus Facilities	Starbucks, MacDonald, Post Office, Library, etc.
15 Facilities Around the School (e.g., Supermarket, bank)	Restaurant, Night Market, Bank, Supermarket, Coffee shops, Beauty shop, hospital, etc.
16 Weather	Mar. to May : 20-25°C; Jun. to Aug. 27-35°C; Sep. to Nov. 20-28°C; Dec. to Feb. 10-22°C. (averagely) In Taiwan, we don't have heating at home or in school. Therefore, we suggest students to bring warm clothes during SPRING semester.
17 Other Information	Mattress pads, blankets, pillow, toiletries, cloth washing powder, etc., can be purchased locally, at an expense of about NT\$10,000.